

## INSTALLATION

Brikseal can only be installed over air bricks before the floodwater rises to a level where any of the seal will be in contact with the water.

More than one Brikseal can be overlaid on each other to cover larger air bricks.

Brikseal can be applied to a rain-wetted wall.

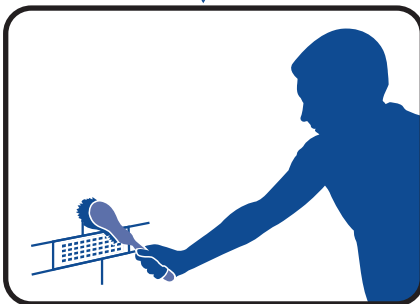

### 1. CLEAN

Clean away any loose debris or surface dirt from the air brick and its immediate surroundings with a stiff brush.

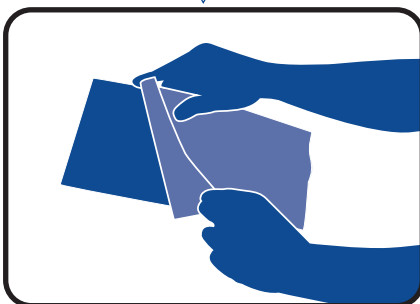

### 2. PEEL

Remove the protective backing from the Brikseal.

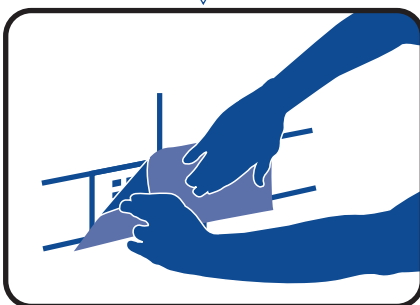

### 3. STICK

Place the Brikseal over the air brick and apply pressure to ensure that there are no gaps between the Brikseal and the air brick and surrounding wall.

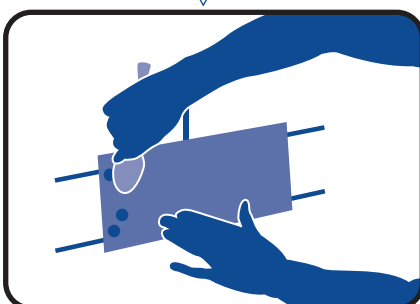

### 4. SMOOTH & SEAL

If there are any gaps, use the back of a tablespoon pressed firmly on the Brikseal (working from the centre outwards to the edges) to ensure good adhesion to the air brick and surrounding wall. The Brikseal should be pressed well into the mortar courses around the air brick.

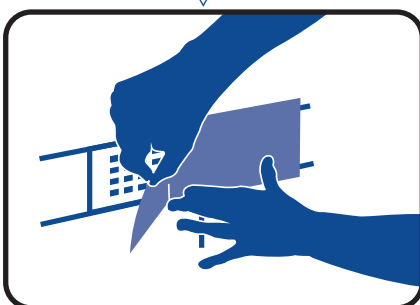

### 5. REMOVAL

Remove the Brikseal after the flood waters have receded to allow air to circulate as normal through the air brick.

Brikseal can be removed by peeling it away carefully from one corner. Dab the adhesive face of the Brikseal onto any adhesive residue to remove it. If any adhesive still remains on the air brick or wall afterwards, it can be removed using a cloth soaked in paintbrush cleaner.